

# About Questions and comments to the Speakers

We will accept questions and comments from the symposium participants in real time using the online question and answer tool "Slido".

## How to access Slido

- Please log in using the URL or QR code provided.
- After successful login you will get the screen as shown in the right.



Slido URL

<https://app.sli.do/event/>

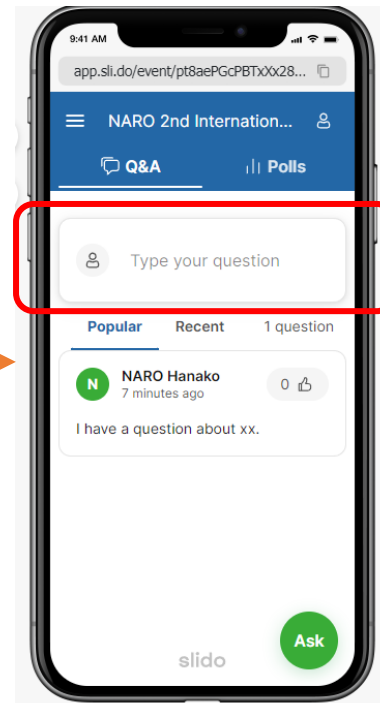

## How to post questions/comments

- ① Tap 「Type your question」
- ② In this column you can send your question/comment. Please mention the speaker's name also
- ③ Please enter your name
- ④ Tap 「Send」 to post your question/comment

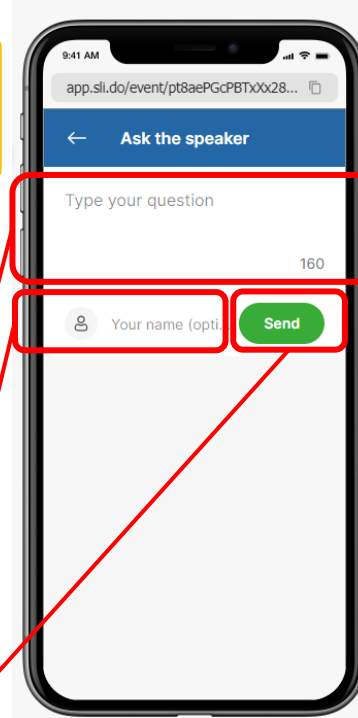

- Please refrain from sending questions unrelated to the symposium
- Answers to the questions will be published on the special site later.
- Please note that it may not be possible to answer all questions.